



Exmoor

The innovators

GROMMETS

- ✓ All items listed on the Department of Health's Prosthesis List.
- ✓ 100% rebate means No gap fees for patients (subject to DOH conditions).
- ✓ GST free

SHEPARD'S DRAINS – for short term ventilation (4 – 9 months)

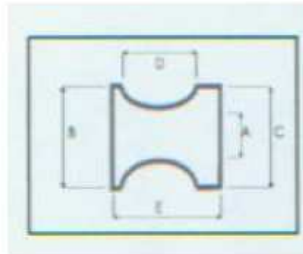

Order Code	Pack Qty	Grasping Feature	Material	Colour	Lumen Dia ø A	Inner Flange ø B	Outer Flange ø C	Inter-Flange mm D	Total length mm E	Sterilized by...
E.102	25	none	ptfe	white	1.14	2.36	2.36	1.42	2.41	steam
E.104	25	None	ptfe	white	0.97	2.08	2.08	1.42	2.41	steam

COLLAR BUTTONS – for short term ventilation (7 – 9 months)

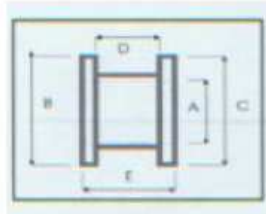

Order Code	Pack Qty	Grasping Feature	Material	Colour	Lumen Dia ø A	Inner Flange ø B	Outer Flange ø C	Inter-Flange mm D	Total length mm E	Sterilized by...
E.106	25	none	ptfe	white	1.14	2.24	2.24	1.27	1.78	steam
E.107	25	none	ptfe	white	1.14	3.0	3.0	1.27	1.78	steam
E.108	25	none	ptfe	white	1.4	2.55	2.55	0.85	1.35	steam
E.109	25	none	ptfe	white	1.75	2.85	2.85	0.95	1.46	steam

Materials legend: ptfe : Teflon sr : silicon rubber



Contact C.R. Kennedy for more information:

VIC 03 9823 1812 | NSW 02 9552 8341 | QLD 07 3632 6717 | SA 08 8410 8105 | WA 08 9489 8544

email sales@crkennedy.com.au | web crkennedy.com.au

REUTER BOBBIN – for medium term ventilation (12 – 18 months)

The shortness of the tube means that it is highly unlikely to abrade the mucous membrane of the middle ear, which might cause the lumen to become blocked with a blood clot or serum. The unusually wide flange extends the period of patency, especially when fenestrated, so that tissues of the tympanic membrane may penetrate them to act as stabilizing dowels.

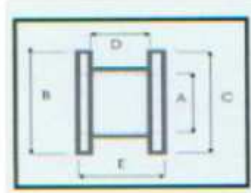

Order Code	Pack Qty	Feature	Material	Colour	Lumen Dia ø A	Inner Flange ø B	Outer Flange ø C	Inter-Flange mm D	Total length mm E	Sterilized by...
E.111	25	no holes	ptfe	white	1.14	2.54	2.54	0.76	1.52	steam

✓

DONALDSON GROMMET – for medium term ventilation 12 – 18 months)

A soft silicone product. The compressibility of this tube permits insertion with minimal tympanic trauma. They resume their shape when released in situ and the design makes for good retention.

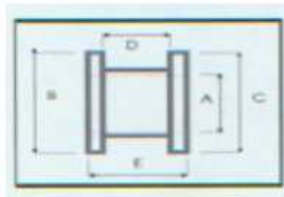

Order Code	Pack Qty	Grasping Feature	Material	Colour	Lumen Dia ø A	Inner Flange ø B	Outer Flange ø C	Inter-Flange mm D	Total length mm E	Sterilized by...
E.154	25	tab	sr	blue	1.1	2.25	2.25	0.76	2.25	steam

✓ **Materials legend:** ptfе : Teflon sr : silicon rubber

✓

✓ **Supplied as a box of 25.**

✓ *Sterile items cannot be returned. Please choose with care.*

✓ **Ask your Product Specialist for more information**